



Welcome to the  
2024-25  
School Year!



# Academic Excellence with a Biblical Worldview



Equipping the next  
generation of Christians  
to be prepared  
spiritually, emotionally,  
and academically.

# Staff Introductions



“Because of your partnership in the gospel from the first day until now, being confident of this, that he who began a good work in you will carry it on to completion until the day of Christ Jesus.” (Phil 1:5-6)



# Campus Advisory Committee

**Dave Wilcke** - Chair, HPC Elder

**Luke Anderson** - HPCS Principal

**Frank Pekovich** - HPC Elder

**Kris Pepler** - HPC/HPCS Librarian; HPC Member

**Chuck Moore** - Executive Director of Impact Christian Schools

**Elizabeth MacKenzie** - HPCS Parent

**Mark MacKenzie** - HPCS Parent

**Cindy Kunde** - Retired HPCS Faculty; HPCS Grandparent

The background is a vibrant orange-red color. It features stylized, flame-like shapes in shades of yellow and orange. Two corn cobs are depicted: one at the top right and one at the middle right, both with wavy lines above them suggesting steam or smoke. The text is centered and rendered in white with a dark red drop shadow.

ALL-CHURCH  
**BBQ**

**SEPTEMBER 8 // 10:00AM - 2:00PM**

# Spiritual Emphasis

**James 1:22-25** “Do not merely listen to the word, and so deceive yourselves. Do what it says. Anyone who listens to the word but does not do what it says is like someone who looks at his face in a mirror and, after looking at himself, goes away and immediately forgets what he looks like. But whoever looks intently into the perfect law that gives freedom, and continues in it—not forgetting what they have heard, but doing it—they will be blessed in what they do.”

**Main Idea:** We need to get beyond head knowledge. God wants us to fall in love with Him, desire a relationship with Him because He loves us, to obey Him because we love and trust Him. He wants our hearts. We need to go deeper.





# School Communication

- High Point Highlights (on Fridays!)
- Text Alerts (more later!)
- Emails
- Family Portal
- Follow us on Facebook and Instagram! (HPCS Families Facebook Group)

# School Communication

- Office email address is [office@hpcsmadison.org](mailto:office@hpcsmadison.org)
- How to handle:
  - Advanced absence requests
  - Sick child notification
  - Early or alternate pickup
  - After school care changes





# Family Portal

The screenshot shows the top portion of the HPCS website. On the left is the HPCS logo with the text "HIGH POINT CHRISTIAN SCHOOL". To the right of the logo is a navigation bar with icons for a bell, a calendar, a graduation cap (highlighted with a yellow circle), an information icon, and a search icon. Below the navigation bar is a horizontal menu with the following items: ABOUT, ADMISSIONS, ACADEMICS, SCHOOL LIFE, and PRESCHOOL. The "ABOUT" item is currently selected, indicated by a red underline. Below the navigation bar is a large banner image showing graduates in maroon gowns throwing their caps. On the left side of the banner, there is a grey box with the text "Academic Excellence" and a sub-headline "Equipping the next generation of Christians to be prepared spiritually, emotionally, and academically." Below this text is a white button that says "LEARN MORE". On the right side of the banner, there is a vertical red menu with the following items: About, Accreditation, Faculty & Staff, Career Opportunities, Giving, and Impact Christian Schools. At the bottom right of the banner, there is a "Join Our Team!" button.

District Code = HP-WI

This screenshot shows a different view of the HPCS website. At the top is the HPCS logo and the text "HIGH POINT CHRISTIAN SCHOOL". To the right of the logo is a navigation bar with icons for a bell, a calendar, a graduation cap, an information icon, and a search icon. Below the navigation bar is a horizontal menu with the following items: ABOUT, ADMISSIONS, ACADEMICS, SCHOOL LIFE, and PRESCHOOL. Below the navigation bar is a sidebar menu with the following items: HP-WI, School, School Home, Calendar, Directory, and Classes. The "School" item is currently selected. To the right of the sidebar menu is a main content area. At the top right of the main content area, there is a small box with the text "High Point Christian School 2024-2025". Below this is a large box with a black border. Inside this box, there are two sections. The first section is titled "Announcements" and contains a sub-section titled "2024-2025 School Supply Lists" with the text "2024/2025 SCHOOL SUPPLY LISTS 3K AM Supplies 24/25 4K PM Day Supplies 24/25 3K Full Day Supplies 24/25 4K Full Day Supplies 24/25 Kindergarten S...". The second section is titled "Raise Right Summer Schedule" and contains the text "Keep raising funds with Raise Right gift cards all summer long! In addition to on demand e-card purchases both online and in the app, orders for physi..."

# Family Portal



ABOUT

ADMISSIONS

ACADEMICS

SCHOOL LIFE

PRESCHOOL

HP-WI

High Point Christian School  
2024-2025



Family

Family Home

Apply / Enroll

Financial

Back To School Site

Family Members

Jill Besley (Mother)

Contact Info



# Family Portal



HIGH POINT  
CHRISTIAN SCHOOL



ABOUT

ADMISSIONS

ACADEMICS

SCHOOL LIFE

PRESCHOOL

HP-WI

High Point Christian School  
2024-2025



Family



Family Home



Apply / Enroll



Financial



Back To School Site

### Enrolled Students

Eliza Besley	Student Demographic Form	01/13/2015   2:13PM
John Besley	Student Demographic Form	
Hannah Besley	Student Demographic Form	

### Student Medical

Eliza Besley	Student Medical Form	01/13/2015   2:17PM
John Besley	Student Medical Form	
Hannah Besley	Student Medical Form	

### Custodial Parents

Michael Besley	Custodial Parent Form	01/11/2017   2:29PM
Bill Besley	Custodial Parent Form	00/12/2023   10:55AM

# Family Portal



ABOUT

ADMISSIONS

ACADEMICS

SCHOOL LIFE

PRESCHOOL

HP-WI

High Point Christian School  
2024-2025



School

School Home

Calendar

Directory

Classes

School My Classrooms My Homework

SUBSCRIBE



< Previous Next >

August 2024

Category  
-All Categories-

Format  
Calendar

Day Week Month

Sun	Mon	Tue	Wed	Thu	Fri	Sat
28	29	30	31	1	2	3

# Family Portal

## There's an App for that!

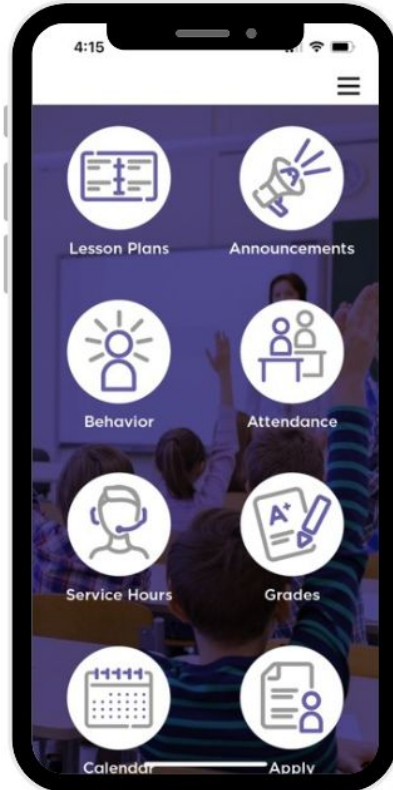

- Sync your calendar!
- Order Hot Lunch
- See newest announcements
- Grades
- Schedules
- Directory
- Homework
- Update medical and family information

# Family Portal

## There's an App for that!

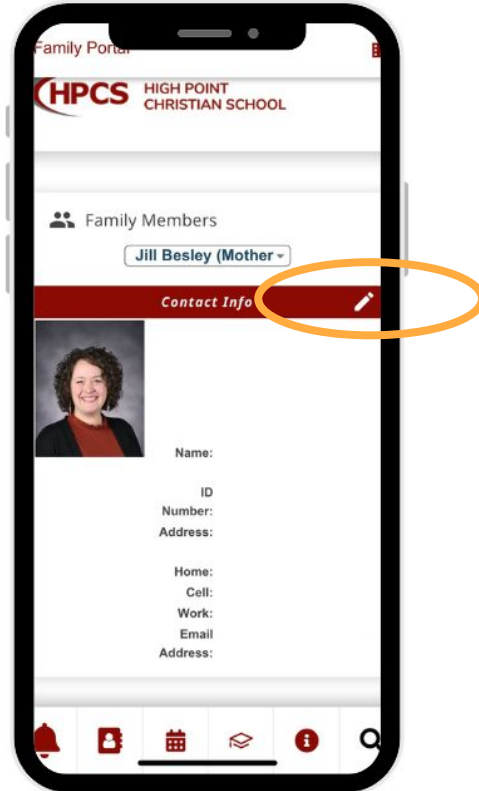

- Sync your calendar!
- Order Hot Lunch
- See newest announcements
- Grades
- Schedules
- Directory
- Homework
- Update medical and family information

# Family Portal

## There's an App for that!

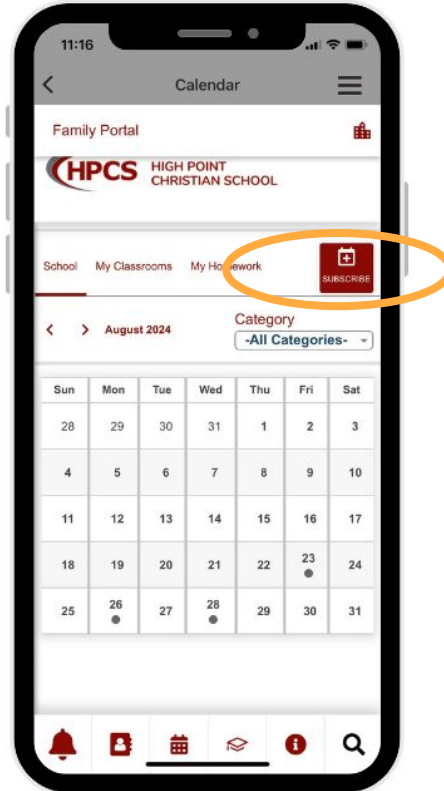

- Sync your calendar!
- Order Hot Lunch
- See newest announcements
- Grades
- Schedules
- Directory
- Homework
- Update medical and family information

# School Schedule

- Doors open at 7:50 a.m.; **NO EARLY DROP-OFFS**
- Day begins at 8:00 a.m.
- Specific period times are listed in the HPCS Family Handbook
- Students released at 3:23 p.m.
- PLEASE NOTE - the release time for half days is 12:10.





# School Schedule

- Tardy Policy (HR/Period Tardies)
- Doors locked at 8:00am
- Parent Alerts (tardies, snow days, rainy-day release, etc)
- Test the Parent Alert tonight (7:45pm)



# First Week of School

- August 28th for PreK - 8th
- Parents may walk students in
  - 1st day only!
  - Kindergarten as needed through 3rd quarter
- PreK parents walk preschool students in every day
- Older siblings should continue to their homerooms independently



# Protocol During Carpool (ES)

## Option #1 Assemble in Carpool Line

- Have your yellow family name tag visible on your visor.
- Follow the direction of traffic for student safety.
- Teachers in K-4 will bring your child(ren) to cars. *Please do not get out of your vehicle.*
- Pull to the front lot if you need to buckle your child.

## Option #2 Park & Pick Up Students in Carpool Area

- Use Sidewalk
- No Pets

# Protocol During Carpool (MS)

## Option #1 (Only Middle School Students)

- Park in the 1st tier parking lot in the front of the building (behind Old Sauk Road)
- Your MS student will walk out the church doors and proceed to your vehicle.

## Option #2 (Middle School and Elementary Students)

- (Preferred) Park in the first tier lot and gather your MS student(s), then enter the K-4 line to get your ES student(s).

**OR**

- Enter the carpool line, gather your ES student(s) then pull around to the front of the building and gather your MS student(s)

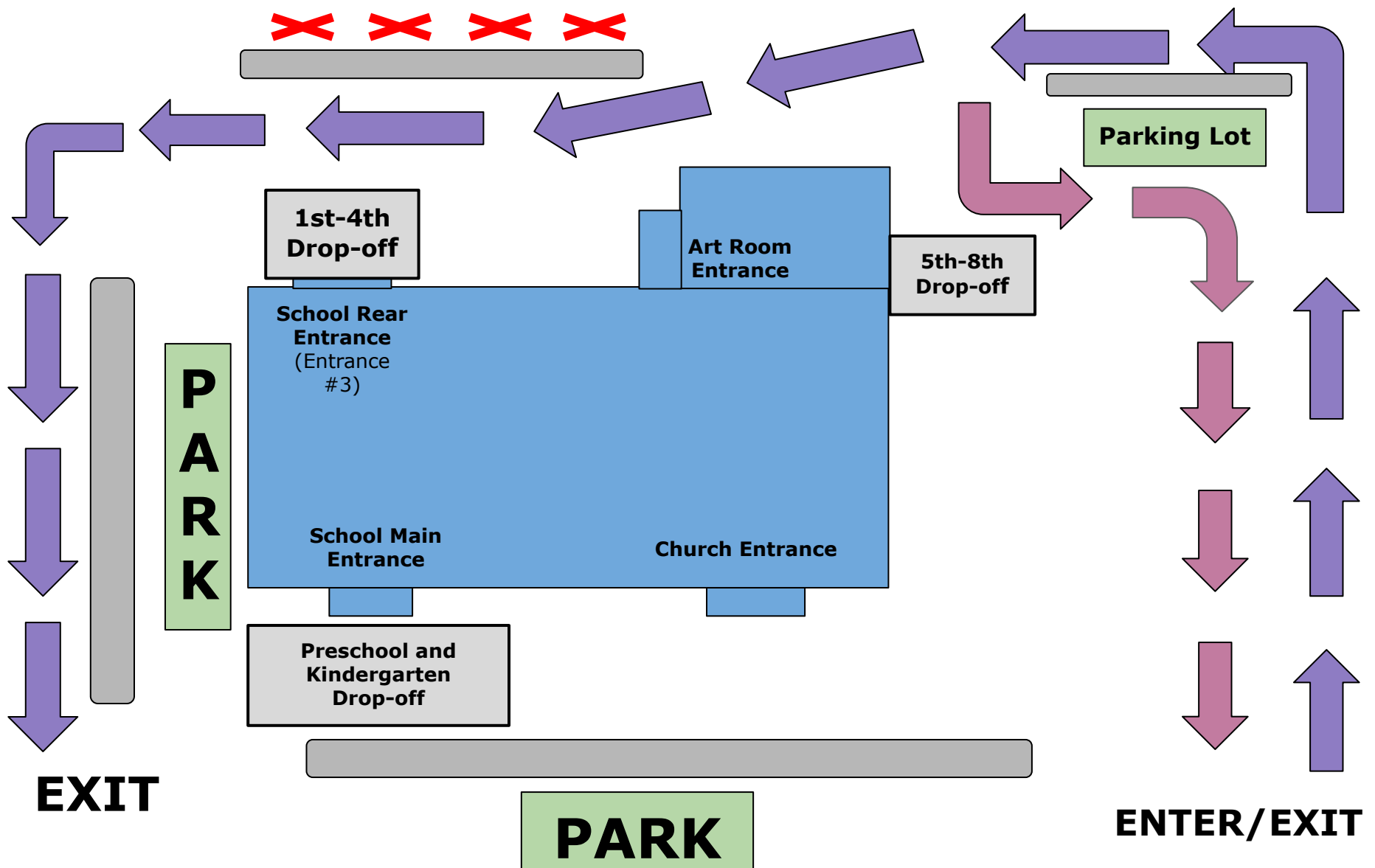

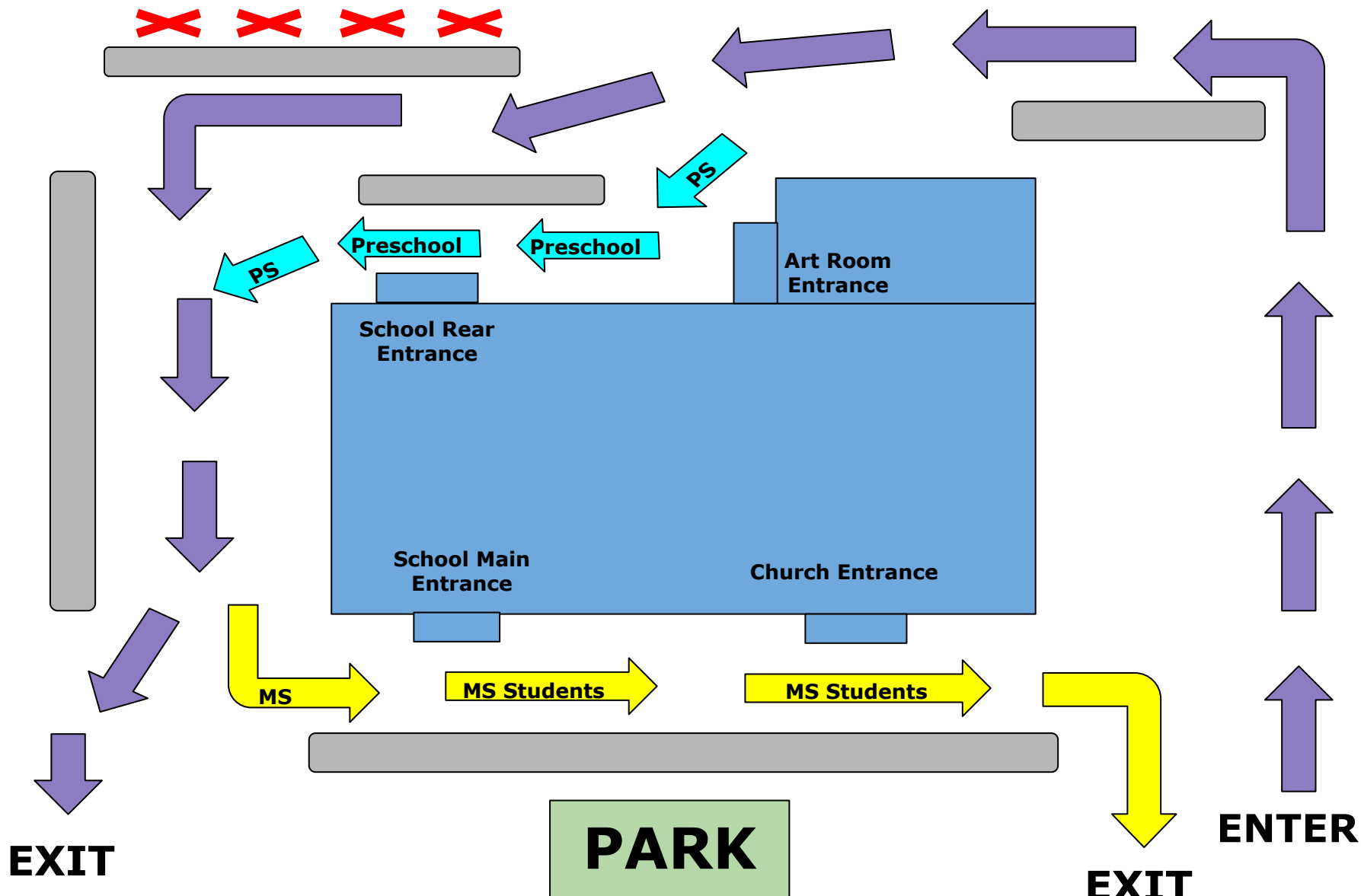

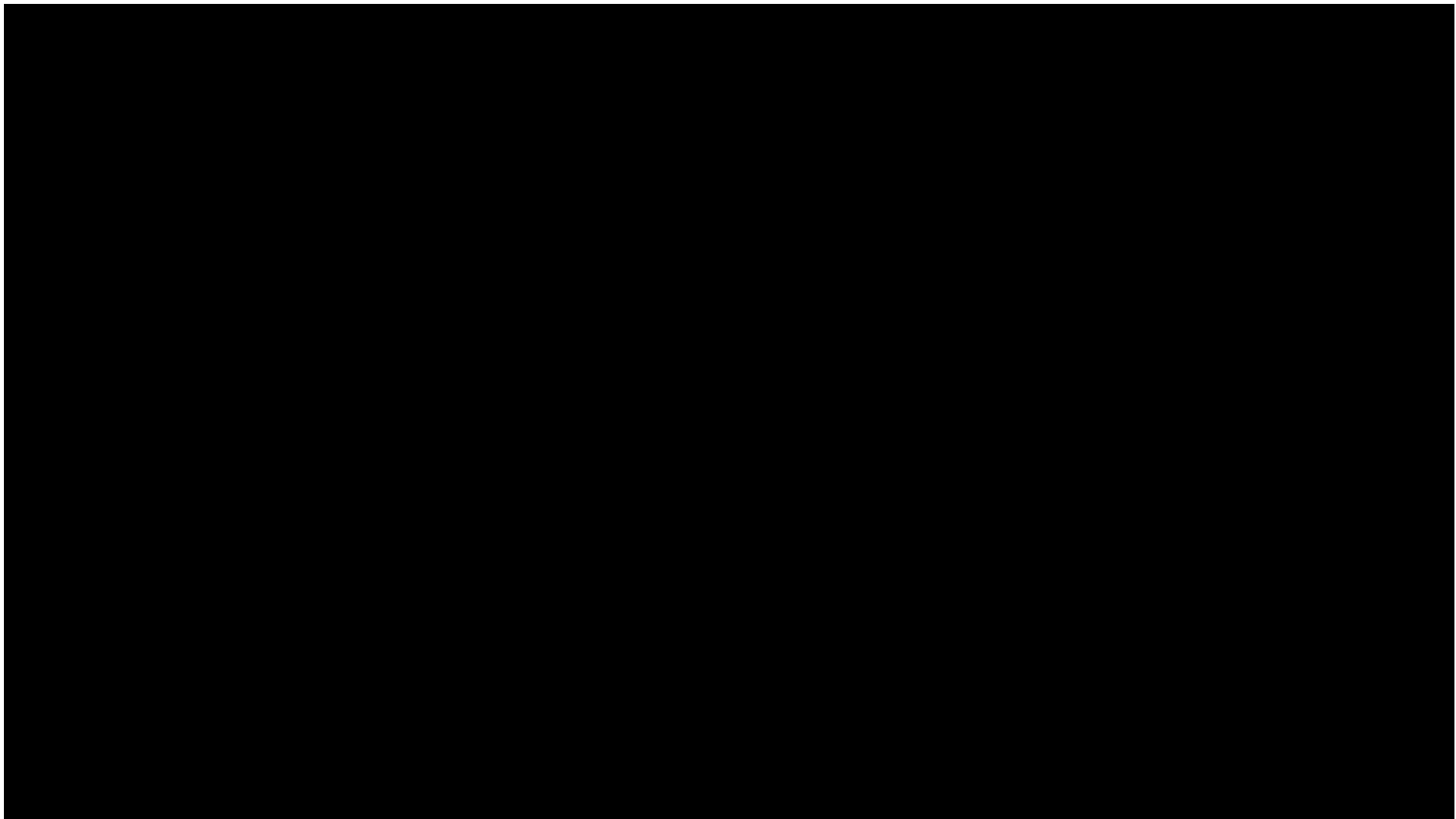

# School Safety

- HPCS is a Safe School!
  - Safety Trainings for Faculty and Staff
  - Drills
  - HPCS Reporting Form (See something Say Something)
  - Building Safety
- What can you do as a parent? Respect the safety features we have in place - no piggybacking please!



# See Something Say Something

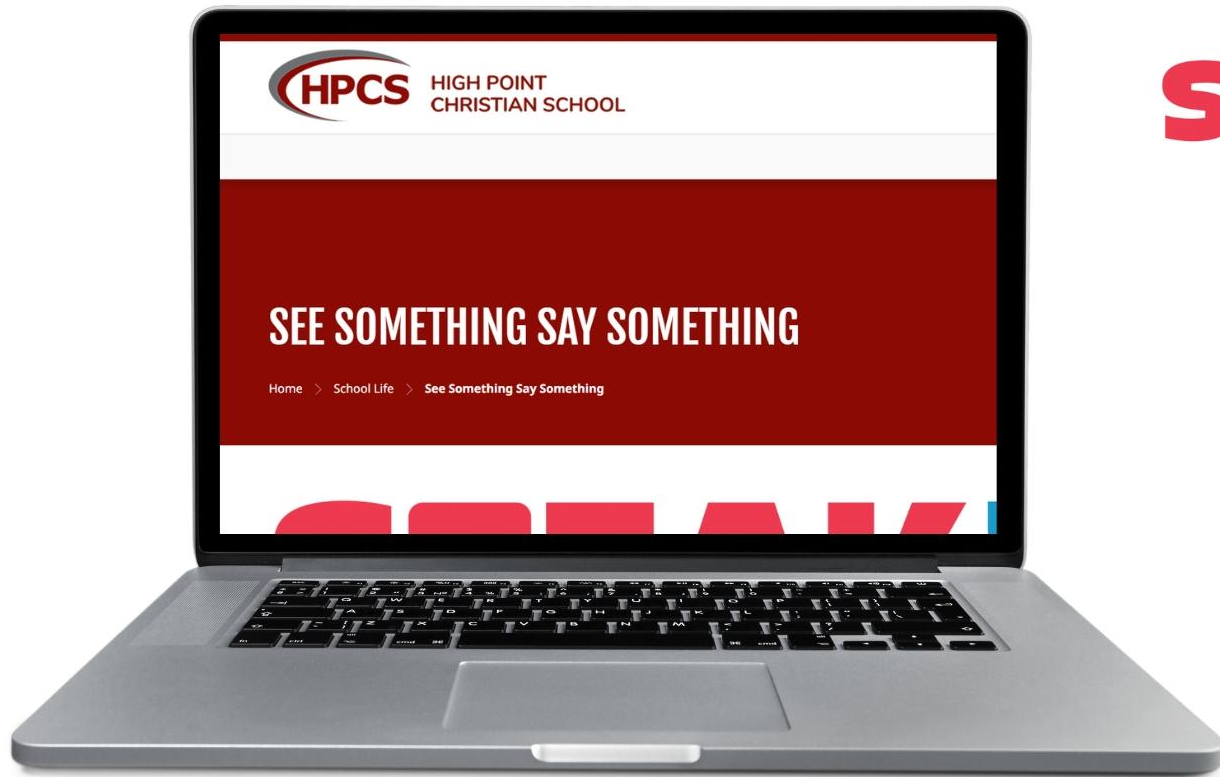

**SPEAK** UP  
**OUT**



# HPCS Reporting Form

Please fill out this anonymous form if you've witnessed or been made aware of any violence at or towards HPCS or if you, personally, have been a victim of violence (examples include but are not limited to bullying, threats of violence, etc).

**Date of Incident:**

m/d/yyyy

**Incident details - What do you want the school to know about what happened?**

**Name: (optional)**

**Email or Phone: (optional)**

**About you:**

- I am the person this incident happened to
- Someone else reported this incident to me
- I observed the incident

# Family Portal



# Absence Policy

(The full HPCS Absence Policy is found in section 5.11 of the Family Handbook)

- Leaving Early?
  - MS: Email the office AND [middleschool@hpcsmadison.org](mailto:middleschool@hpcsmadison.org)
  - PS, ES: Email the office AND homeroom teacher

# Absence Policy

## **Absences due to travel or other non-medical reasons**

(Full policy is in section 5.12 of the Family Handbook)

- For more than two days, fill out the Advance Absence Form
- Limited to 10 days per year
- Homework make-up due to travel policy
- A link to the form is available on the Family Portal and website.

# Absence Policy

## Requesting Homework When Your Student is Absent due to Illness

(Full policy is in section 6.3 of the Family Handbook)

- MS: email [middleschool@hpcsmadison.org](mailto:middleschool@hpcsmadison.org) **before 8:45am**; homework will be ready at 3:15
- Grades 3-4: email the homeroom teacher **before 8:45am**; homework will be ready at 3:15
- Grades K-2: work will be made up when your student returns
- Alternate arrangements will be made for students absent due to illness for an extended period of time.

# Contact Information

(Full chart is found in section 7.7 of the Family Handbook)

- Who to contact regarding academic and grading concerns, homework questions, discipline issues, etc

<b>Question or Concern</b>	<b>1<sup>st</sup> Contact</b>	<b>2<sup>nd</sup> Contact</b>	<b>3<sup>rd</sup> Contact</b>
Academic Concerns Preschool	Teacher of class	Preschool Lead Teacher	Principal
Academic Concerns Grades K-4th	Teacher of class	Elementary Lead Teacher	Principal
Academic Concerns Grades 5th-8th	Teacher of class	Middle School Lead Teacher	Principal
Academic Concerns Specials Classes	Teacher of class	Specials Lead Teacher	Principal
Grading Concerns Grades K-4th	Teacher of class	Elementary Lead Teacher	Principal

# Personal Electronic Devices

Any device that:

- displays a message or video image
- is capable of receiving, sending, emitting, photographing, or storing any video communication, files, or data.





# Personal Electronic Devices

- Includes (but is not limited to) items that allow the student to access the internet, or an accessory to any such device such as earphones or Bluetooth devices.
- Exclusions for medically necessary devices, with appropriate documentation from a physician, will be handled on a case by case basis.



# Personal Electronic Devices

Grades K-4th:

No personal electronic devices  
are allowed at school.



# Personal Electronic Devices

## Grades 5th-8th:

- Personal electronic devices **may not** be used by students inside the school during school hours.
- Each middle school homeroom will have their own designated “phone tree.”



# Personal Electronic Devices

## Grades 5th-8th:

- Students must place all cell phones, smart watches, etc. in the classroom phone tree at the beginning of the school day with the device turned off.
- Mrs. Krumbach will have more information.



# Dress Code



- The purpose of this dress code is to reflect the **virtues of modesty and self-respect.**
- The HPCS dress code applies to all **K-8th students.**
- Full text of the dress code policy can be found in the HPCS Family Handbook

# Lunchroom

- Lunch ordering - Due **TODAY!**
- Milk
- Absences
- Lunchroom volunteers: 4 per family



Anne Yaroch

[ayaroch@hpcsmadison.org](mailto:ayaroch@hpcsmadison.org)



# Student Services



**Sheila Olson**  
Director of  
Student Services

[solson@hpcsmadison.org](mailto:solson@hpcsmadison.org)



**Trisha Pinka**  
Elementary Student  
Services Teacher

[tpinka@hpcsmadison.org](mailto:tpinka@hpcsmadison.org)



**Jennifer Kutsunis**  
Middle School Student  
Services Teacher

[jkutsunis@hpcsmadison.org](mailto:jkutsunis@hpcsmadison.org)

# Aspire Therapy and High Point Christian School Partnership

## Providing:

- Speech and Language Therapy
- Occupational Therapy
- Physical Therapy

This therapy is provided to students during the school day.

## Who does Aspire See?

- Students supported by the Special Needs Scholarship Program (SNSP) that have an IEP with their home school district
- Students who do **not** have SNSP support/IEP, but parents/family have elected to access our therapy services through insurance coverage



**Aspire**

Therapy & Development Services



# Aspire Therapy and High Point Christian School Partnership

**Are you interested in learning more? Do you have any questions?**

Talk with your child's teacher or email:  
Aimee Hoof, Aspire Private School Program Coordinator  
[Aimee.Hoof@aspirewisconsin.com](mailto:Aimee.Hoof@aspirewisconsin.com)

# Athletics

- Flag Football
- Girls Volleyball
- Cross Country
- Boys Basketball
- Girls Basketball
- Boys Volleyball
- Softball
- Track

## Contact Information

Athletic Director:

Mike Asen

[masen@hpcsmadison.org](mailto:masen@hpcsmadison.org)

**Register your student  
for athletics today!**



# Room Parents

Ideally we would like to have two parents assigned to each homeroom class.

Duties include:

- Working with the PSO
- Working with the homeroom teacher to plan parties and other special events
- Planning very low-key social get togethers for the class outside of school
- Assisting the homeroom teacher as requested
- Sign up in the gym tonight or email the office



## **Parent Support Organization**

The PSO provides support to HPCS faculty, staff, students and families. Our leadership team this year is:

- Jill Tester
- Tania Van Orden
- Hanna Wilmer
- Rachel Zilli



## Staff Appreciation

- Staff Birthdays
- In-Service Days
- Testing Week Snacks
- Flowers for Christmas/Spring Sing Program
- Souper Lunch
- Teacher Appreciation Week (coordinated Taco Day, Breakfast, & Trail Mix)
- Christmas and End of Year gifts



## PSO Community Events/Fundraising

- Restaurant Nights
- Cookie Dough Sale
- Ice Cream Social



## Schedule for Tonight

- **Classroom Session #1** - 7:20 - 7:50pm
- **Classroom Session #2** - 8:00 - 8:30pm
- Middle School: Meets in Micah A/B
- Tables for Specials, lunchroom, and athletics will be available in the gym throughout the evening until 8:45pm